

STATE	REFERENCE PROJECT NO	FISCAL YEAR	SHEET NO	LAST SHEET NO
AL	SCP 59-940-23	2023	1	12

SHELBY COUNTY HIGHWAY DEPARTMENT

PLANS OF PROPOSED PROJECT SCP 59-940-23

TRAFFIC SIGNAL/ITS UPGRADES ON HIGHWAY 52

PELHAM, ALABAMA



STATE LOCATOR

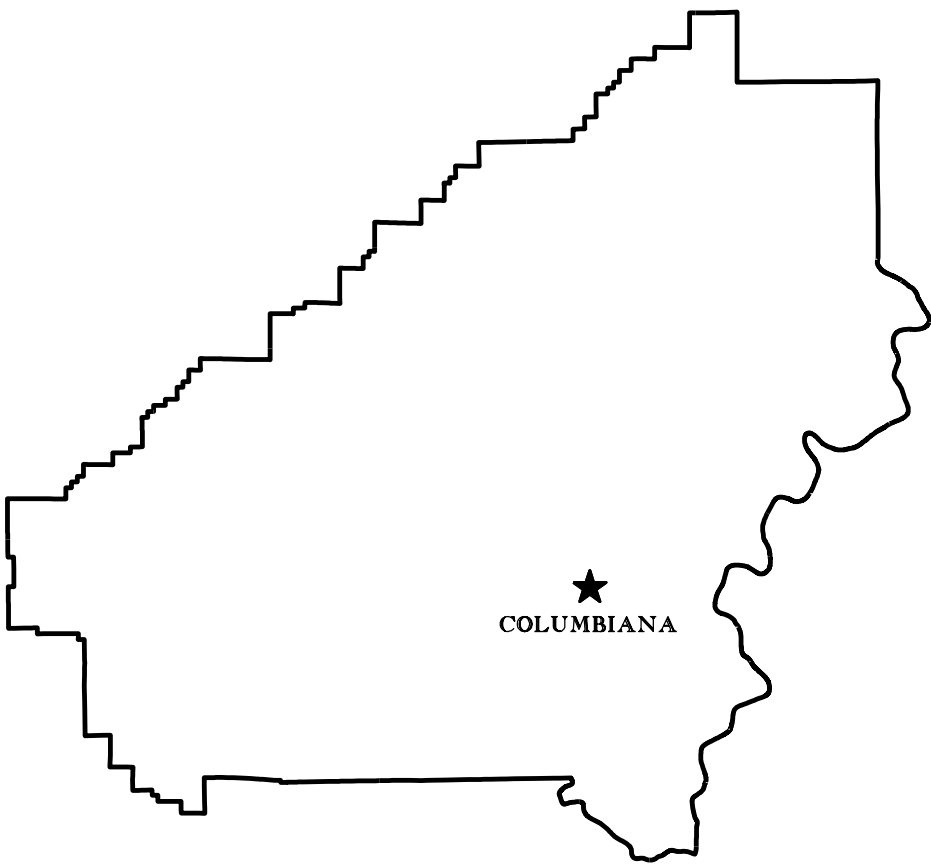

COUNTY ENGINEER

DAVID D. WILLINGHAM, P.E.



COUNTY COMMISSIONERS	
DISTRICT #1	DISTRICT #2
KEVIN MORRIS	TOMMY EDWARDS
DISTRICT #3	DISTRICT #4
JON PARKER	WARD WILLIAMS
DISTRICT #5	DISTRICT #6
ELWYN BEARDEN	JEFF BRUMLOW
DISTRICT #7	DISTRICT #8
LINDSEY ALLISON	RICK SHEPHERD
DISTRICT #9	
DR.ROBBIE HAYES	

NOTE : THESE PLANS HAVE BEEN PREPARED TO

CONFORM WITH ALABAMA DEPARTMENT

OF TRANSPORTATION STANDARD

SPECIFICATIONS DATED 2022

REFERENCE PROJECT NO	FISCAL YEAR	SHEET NO
SCP 59-940-23	2023	1A

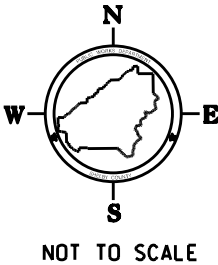
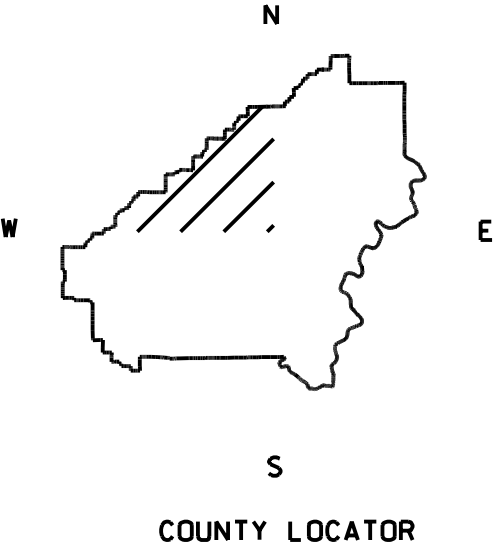
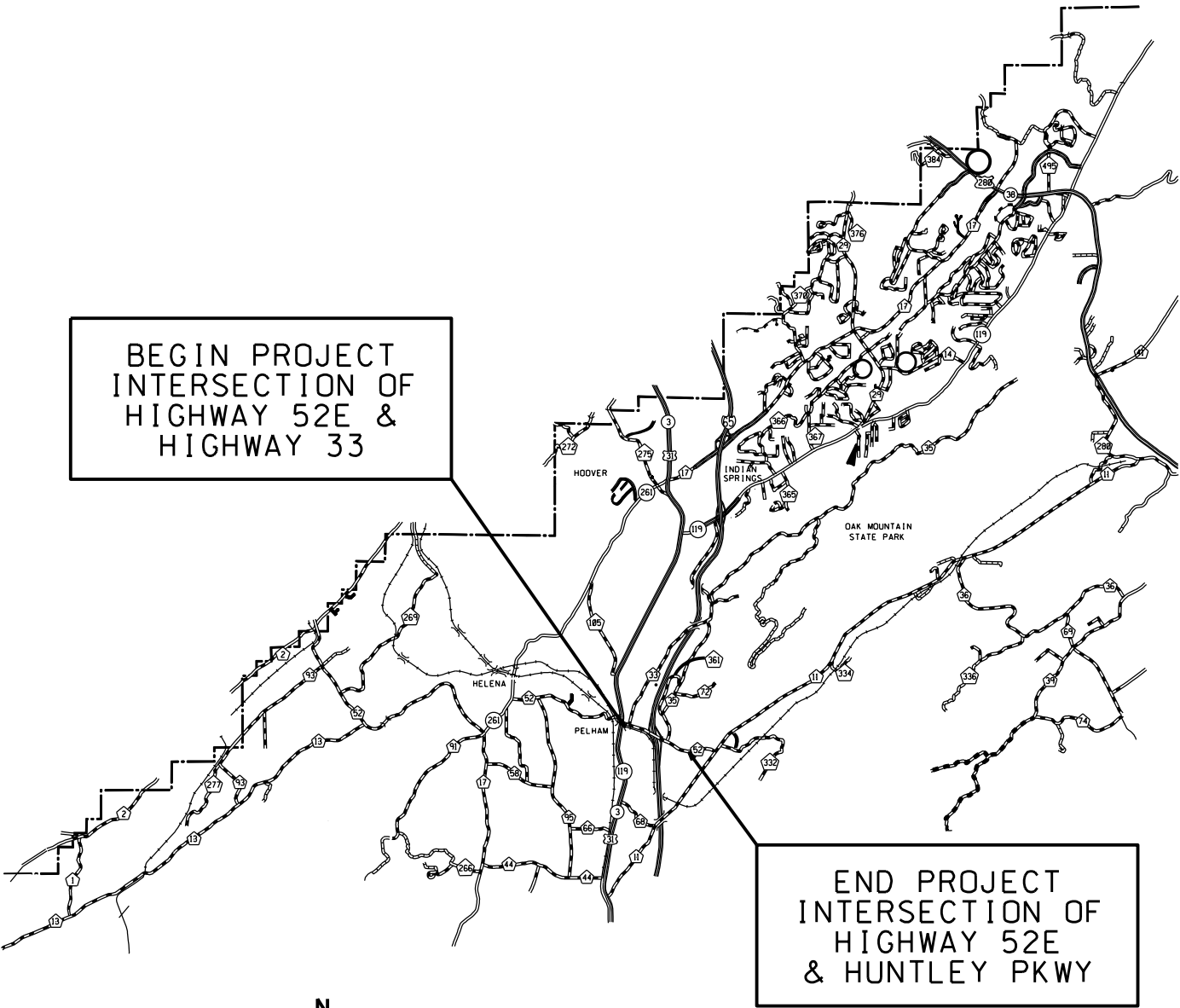

LEGEND	
INTERSTATE HIGHWAY	
U.S. HIGHWAY	
STATE HIGHWAY	
GRADED & DRAINED ROAD	
COUNTY PAVED ROAD	
RAILROAD	

REFERENCE PROJECT NO	FISCAL YEAR	SHEET NO
SCP 59-940-23	2023	1B

INDEX TO SHEETS
PROJECT NO. SCP 59-940-23
SHELBY COUNTY

SHEET NO. 1	TITLE SHEET
SHEET NO. 1A	PROJECT LOCATION
SHEET NO. 1B	INDEX TO SHEETS
SHEET NO. 2-2B	PROJECT NOTES
SHEET NO. 3-3A	SUMMARY OF QUANTITIES
SHEET NO. 4	TRAFFIC SIGNAL PLAN - HIGHWAY 52E AT HIGHWAY 33
SHEET NO. 5	TRAFFIC SIGNAL PLAN - HIGHWAY 52E AT I-65 SB RAMP
SHEET NO. 6	TRAFFIC SIGNAL PLAN - HIGHWAY 52E AT I-65 NB RAMP
SHEET NO. 7	TRAFFIC SIGNAL PLAN - HIGHWAY 52E AT MCCAIN PKWY
SHEET NO. 8	TRAFFIC SIGNAL PLAN - HIGHWAY 52E AT RACQUET CLUB PKWY
SHEET NO. 9	ITS PLAN - SCHEMATIC DETAIL
SHEET NO. 10	ITS PLAN - SCHEMATIC DETAIL
SHEET NO. 11	TRAFFIC CONTROL PLAN
SHEET NO. 12	TRAFFIC CONTROL PLAN

THE FOLLOWING IS A LIST OF STANDARD OR SPECIAL DRAWINGS CONTAINED IN THE STATE OF ALABAMA HIGHWAY DEPARTMENT SPECIAL AND STANDARD HIGHWAY DRAWINGS BOOKLET DATED 2022 WHICH APPLY TO THIS PROJECT:

<u>INDEX NO.</u>	<u>DRAWING NO.</u>	<u>DESCRIPTION</u>
73004	T.S.D.-730-2	METAL TRAFFIC SIGNAL POLE AND LIGHTING INSTALLATION DETAILS
73027	T.S.D.-730-10	BASE ND POLE MOUNTED CONTROLLER CABINET INSTALLATIONS
74007	TCD-100	DETAILS FOR TRAFFIC CHANNELIZATION DEVICES

REFERENCE PROJECT NO	FISCAL YEAR	SHEET NO
SCP 59-940-23	2023	2

PROJECT NOTES
PROJECT NO. SCP 59-940-23
SHELBY COUNTY

200. WHEN THE CONTROLLER IS IN THE FLASHING MODE, THE VEHICULAR SIGNAL HEADS SHALL FLASH YELLOW ON HWY 52E, RED ON ALL CROSS STREETS, AND RED ON PROTECTED LEFT TURNS.
201. ALL EXISTING TRAFFIC CONTROL EQUIPMENT WHICH IS THE PROPERTY OF THE COUNTY INCLUDING SIGNAL HEADS, CONTROLLERS, POLES, AND MISCELLANEOUS HARDWARE SHALL BE REMOVED UPON COMPLETION OF THE NEW TRAFFIC CONTROL UNIT BE DELIVERED TO THE COUNTY OR DISPOSED OF AS DIRECTED BY THE ENGINEER.
202. AS WORK BEGINS RELATED TO OR AFFECTING THE SIGNAL(S), WITHIN THE CONSTRUCTION LIMITS, THE CONTRACTOR SHALL ASSUME RESPONSIBILITY OF ALL EXISTING, TEMPORARY, AND REQUIRED SIGNAL(S). THE CONTRACTOR SHALL BE RESPONSIBLE FOR CONTINUAL OPERATION AND MAINTENANCE OF THE SIGNAL(S) UNTIL ALL SIGNAL WORK OR WORK AFFECTING THE SIGNAL(S) ACCEPTED BY THE COUNTY.
203. THE CONTRACTOR SHALL BE RESPONSIBLE FOR CONTACTING ALL UTILITY COMPANIES TO LOCATE ALL OVERHEAD AND UNDERGROUND UTILITIES, WHETHER SHOWN ON THE PLANS OR NOT. DAMAGE TO UTILITIES CAUSED BY THE CONTRACTOR SHALL BE REPAIRED BY THE CONTRACTOR TO THE SATISFACTION OF THE UTILITY COMPANY AND THE ENGINEER. THE CONTRACTOR SHALL BEAR ALL COSTS TO REPAIR ANY AND ALL DAMAGES TO THE UTILITIES CAUSED BY THE CONTRACTOR.
204. THE CONTRACTOR SHALL BE RESPONSIBLE FOR REPAIRS OF DAMAGE TO AND ROADWAY, LIGHTING, OR BRIDGE ELEMENTS THAT OCCUR DURING THE CONSTRUCTION OF THIS PROJECT DUE TO HIS OPERATIONS. THE METHOD OF REPAIR SHALL BE APPROVED BY THE ENGINEER PRIOR TO REPAIRS BEING DONE. ANY COST OF SUCH REPAIRS SHALL BE BORNE BY THE CONTRACTOR.
206. THE COUNTY RESERVES THE RIGHT TO RESPOND TO TRAFFIC CONTROL UNIT(S) MALFUNCTIONS IN AN EMERGENCY OR NATURAL DISASTER. IN DOING SO THE CONTRACTOR'S LIABILITY AND RESPONSIBILITY RELATED TO MAINTAINING THE TRAFFIC UNIT(S) OR SYSTEM REMAINS IN EFFECT.
207. THE CONTRACTOR SHALL HAVE THE APPROVAL OF THE ENGINEER PRIOR TO THE REMOVAL OF ANY EXISTING TRAFFIC CONTROL UNIT. THE CONTRACTOR SHALL NOT REMOVE AN EXISTING TRAFFIC CONTROL UNIT UNTIL THE REQUIRED TRAFFIC CONTROL UNIT IS INSTALLED AND COMPLETELY OPERATIONAL.
208. TRAFFIC SIGNAL LOCAL TIMINGS AND BASE PROGRAMMING WILL BE PROVIDED TO THE CONTRACTOR FOR EACH INTERSECTION PRIOR TO INSTALLATION. THE CONTRACTOR WILL BE GIVEN THE DIGITAL FILES TO DOWNLOAD TO EACH TRAFFIC SIGNAL CONTROLLER.
209. THE CONTRACTOR SHALL SUBMIT TO THE ENGINEER FOR APPROVAL ALL ANCHORS, MOUNTING BRACKETS, CLAMPS AND STRAPS PRIOR TO ANY INSTALLATION OF PRODUCT.
210. IT SHALL BE THE CONTRACTOR'S RESPONSIBILITY TO ENSURE ALL COMPONENTS (INCLUDING, BUT NOT LIMITED TO, CAMERAS AND CAMERA CONTROLS, VEHICLE DETECTION DEVICES, WIRELESS DEVICES, ETHERNET FIELD SWITCHES, DYNAMIC MESSAGE SIGNS, AND VIDEO ENCODERS) ARE COMPATIBLE TO ALDOT'S AUTOMATED TRAFFIC MANAGEMENT SYSTEM (ATMS) AND THAT THEY FUNCTION AS A COMPLETE SYSTEM.
211. IP ADDRESSES WILL BE PROVIDED BY ALDOT FOR EACH TRAFFIC SIGNAL LOCATION. THE TRAFFIC SIGNAL CONTROLLER MANUFACTURER'S REPRESENTATIVE SHALL VERIFY THAT EACH CONTROLLER IS CONNECTED AND COMMUNICATING WITH THE ALDOT NETWORK. ANY COSTS ASSOCIATED WITH THIS IS CONSIDERED A SUBSIDIARY OBLIGATION OF 730C.
212. MISCELLANEOUS HARDWARE AND CABLES REQUIRED FOR THE INSTALLATION OF THE TRAFFIC SIGNAL CONTROLLER, PTZ CAMERAS, AND WIRELESS RADIOS SHALL BE CONSIDERED A SUBSIDIARY COST OF 730C.
213. TRAFFIC SIGNAL CONTROLLERS USED AS A PART OF THIS PROJECT SHALL BE AN ECONOLITE COBALT-C SHELF MOUNT CONTROLLER WITH EOS SOFTWARE.
214. ALL TRAFFIC SIGNAL EQUIPMENT USED ON THIS PROJECT SHALL BE INCLUDED ON THE ALDOT APL.
215. PTZ CAMERAS USED ON THIS PROJECT SHALL BE VIPER PTZ CAMERAS WITH SIDEWINDER WALL MOUNT AND VERTICAL POLE MOUNT ADAPTER.

REFERENCE PROJECT NO	FISCAL YEAR	SHEET NO
SCP 59-940-23	2023	2A
<p style="text-align: center;">TRAFFIC CONTROL NOTES PROJECT NO. SCP 59-940-23 SHELBY COUNTY</p>		
700.	THE TRAFFIC CONTROL PLAN IS DEVELOPED IN CONFORMANCE WITH THE MANUAL ON UNIFORM TRAFFIC CONTROL DEVICES PART 6, 2009 EDITION. THE TRAFFIC CONTROL DEVICES INDICATED REPRESENT CONDITIONS KNOWN DURING PLAN DEVELOPMENT. IN THE EVENT ACTUAL PHYSICAL CONDITIONS WARRANT ADDITIONAL TRAFFIC CONTROL DEVICES, THEY SHALL BE INSTALLED IN CONFORMANCE WITH THE MUTCD PART 6 AS DIRECTED BY THE ENGINEER. COST SHALL BE PAID FOR AS A SUBSIDIARY OBLIGATION.	
701.	THE CONTRACTOR WILL BE PERMITTED TO DEVELOP HIS OWN TRAFFIC CONTROL PLAN TO BE USED IN LIEU OF THIS TRAFFIC CONTROL PLAN IF APPROVED BY THE ENGINEER. A CONTRACTOR DEVELOPED TRAFFIC CONTROL PLAN SHALL BE A SUBSIDIARY COST OF THE CONTRACT.	
702.	THE CONTRACTOR WILL ENSURE THAT ALL TRAFFIC CONTROL DEVICES ARE IN PROPER LOCATIONS AND IN GOOD CONDITION AT ALL TIMES.	
703.	ALL SIGNS AND BARRICADES MAY BE ADJUSTED BY THE ENGINEER FOR THE SAFETY OF THE TRAVELING PUBLIC WHEN NECESSARY.	
704.	ADDITIONAL SIGNS MAY BE REQUIRED IF DEEMED NECESSARY BY THE ENGINEER. ADDITIONAL ITEMS TO BE PAID FOR AS A SUBSIDIARY COST OF THE CONTRACT.	
705.	NO DIRECT PAYMENT WILL BE MADE FOR REMOVING, RELOCATING, OR COVERING OF IN PLACE SIGNS, BARRELS, BARRICADES, OR OTHER TRAFFIC CONTROL DEVICES AS REQUIRED IN THIS TRAFFIC CONTROL PLAN (SEE SPECIAL DRAWING NO. TCD-100 IN THE ALABAMA DEPARTMENT OF TRANSPORTATION'S SPECIAL AND STANDARD HIGHWAY DRAWINGS, 2022 EDITION). COST TO BE A SUBSIDIARY OBLIGATION OF THE CONTRACT.	
706.	THE QUANTITIES SHOWN ON THE TRAFFIC CONTROL PLAN SHEET ARE CONSIDERED TO BE THE MINIMUM REQUIREMENT FOR HANDLING TRAFFIC AT ANY GIVE TIME DURING CONSTRUCTION.	
707.	THE CONTRACTOR IS TO REMOVE, RELOCATE, OR COVER DURING CONSTRUCTION AND THEN RESET UPON COMPLETION OF A PARTICULAR SECTION ANY CONFLICTING IN-PLACE ROADWAY SIGNS AS DIRECTED BY THE ENGINEER. COST TO BE A SUBSIDIARY OBLIGATION OF THE CONTRACT.	
708.	ALL CONSTRUCTION SIGNS PLACED BEFORE WORK BEGINS SHALL BE COVERED WITH BLACK PLASTIC OR SOME OTHER SUITABLE MATERIAL SO THAT THE SIGNS ARE NOT VISIBLE UNTIL WORK IS IN PROGRESS.	
709.	ALL TRAFFIC CONTROL DEVICES SHALL BE PAID AS A SUBSIDIARY COST OF THE CONTRACT.	
710.	ALL BLACK ON ORANGE CONSTRUCTION SIGNS SHALL BE FABRICATED USING TYPES IV OR VIII FLUORESCENT ORANGE REFLECTIVE SHEETING MATERIAL FOR THE SIGN BACKGROUND.	
711.	DURING NON-WORKING HOURS NO EQUIPMENT OR MATERIAL SHALL BE PARKED OR STORED CLOSER THAN 30 FEET TO THE EDGE OF ANY ROADWAY CARRYING TRAFFIC. WHEN THIS IS NOT PRACTICAL, IT SHALL BE PLACED IN AN AREA DESIGNATED BY THE ENGINEER AND DELINEATED BY REFLECTORIZED DRUMS. THIS INCLUDES STORAGE OF TRAFFIC CONTROL DEVICES SUCH AS TRAILER MOUNTED OR OTHER TEMPORARY SIGNS, BARRICADES, DRUMS, ETC., WHICH ARE NOT IN USE DURING NON-WORKING HOURS.	

REFERENCE PROJECT NO	FISCAL YEAR	SHEET NO
SCP 59-940-23	2023	2B

TRAFFIC CONTROL NOTES
PROJECT NO. SCP 59-940-23
SHELBY COUNTY

- 712: WHERE THE LOCATION OF A REQUIRED SIGN FALLS IN A DRIVEWAY, SIDEWALK, BRIDGE, ETC., OR WHERE THE VISIBILITY OF A SIGN IS LIMITED TO THE TRAVELING PUBLIC, THE LOCATION SHALL BE ADJUSTED AS DIRECTED BY THE ENGINEER.
- 713: THE CONTRACTOR SHALL PLACE ALL ADVANCE WARNING SIGNS BEFORE PROCEEDING WITH THIS WORK.
- 714: ALL VEHICLES, EQUIPMENT, PERSONNEL (EXCEPT FLAGGERS), AND THEIR ACTIVITIES, ARE RESTRICTED AT ALL TIMES TO ONE SIDE OF THE PAVEMENT UNLESS OTHERWISE AUTHORIZED BY THE ENGINEER.
- 715: CONTRACTOR SHALL MAINTAIN AT LEAST ONE ACCESS TO BUSINESSES AND RESIDENCES DURING ALL PHASES OF CONSTRUCTION.
- 716: CONSTRUCTION SIGNS MOUNTED ON TEMPORARY SUPPORTS SHALL BE MOUNTED AT A MINIMUM HEIGHT OF 5 FEET.
- 717: FLAGGERS SHALL BE PROPERLY ATTIRED, EQUIPPED WITH STAFF MOUNTED STOP/SLOW PADDLES IN SIGHT OF EACH OTHER, OR HAVE DIRECT COMMUNICATION AT ALL TIMES. FLAGGER STATION LOCATION MAY BE VARIED FROM THOSE SHOWN BASED ON ROADWAY CONDITIONS AT THE TIME OF THE LANE CLOSURE.
- 718: FLAGGERS ARE TO BE USED WHEN DIRECTED BY THE ENGINEER. SIGNS SHALL BE PLACED AT THE APPROPRIATE TIME, AND SHALL BE COVERED OR REMOVED WHEN FLAGGERS ARE NOT ON DUTY AND DURING NON-WORKING HOURS.
- 719: FOR MOVING OPERATIONS, THE TRAFFIC CONES MAY BE DELETED IF THE FLAGGERS ARE IN SIGHT OF EACH OTHER, OR IF A PILOT CAR IS USED ON A TWO LANE ROADWAY.

REFERENCE PROJECT NO		FISCAL YEAR		SHEET NO	
SCP 59-940-23		2023		3	
SUMMARY OF QUANTITIES SCP 59-940-23					
TOTAL	ITEM NO	UNIT	DESCRIPTION		
5	729C-020	EACH	NETWORK DEVICE, TYPE C (FMES)		
4	729C-110	EACH	NETWORK DEVICE, UNLICENSED WMES		
1	729C-200	EACH	NETWORK DEVICE, CELLULAR MODEM		
2	729D-200	EACH	CAMERA, DOME		
1	730C-000	LUMP SUM	FURNISHING AND INSTALLING TRAFFIC CONTROL UNIT (HIGHWAY 52E AT HIGHWAY 33)		
1	730C-001	LUMP SUM	FURNISHING AND INSTALLING TRAFFIC CONTROL UNIT (HIGHWAY 52E AT I-65 SB RAMP)		
1	730C-002	LUMP SUM	FURNISHING AND INSTALLING TRAFFIC CONTROL UNIT (HIGHWAY 52E AT I-65 NB RAMP)		
1	730C-003	LUMP SUM	FURNISHING AND INSTALLING TRAFFIC CONTROL UNIT (HIGHWAY 52E AT HWY 35)		
1	730C-004	LUMP SUM	FURNISHING AND INSTALLING TRAFFIC CONTROL UNIT (HIGHWAY 52E AT RACQUET CLUB PARKWAY/HUNTLEY PARKWAY)		
5	730R-151	EACH	CONTROLLER UNIT, TYPE NEMA		

SUMMARY OF QUANTITIES

SCP 59-940-23

TRAFFIC SIGNAL QUANTITIES

LOCATION	FURNISHING AND INSTALLING TRAFFIC CONTROL UNIT	FURNISHING AND INSTALLING TRAFFIC CONTROL UNIT	FURNISHING AND INSTALLING TRAFFIC CONTROL UNIT	FURNISHING AND INSTALLING TRAFFIC CONTROL UNIT	FURNISHING AND INSTALLING TRAFFIC CONTROL UNIT	CONTROLLER UNIT, TYPE NEMA
	730C-000	730C-001	730C-002	730C-003	730C-004	730R-151
	LUMP SUM	LUMP SUM	LUMP SUM	LUMP SUM	LUMP SUM	EACH
HIGHWAY 52E AT HIGHWAY 33	1	0	0	0	0	1
HIGHWAY 52E AT I-65 SOUTHBOUND RAMP	0	1	0	0	0	1
HIGHWAY 52E AT I-65 NORTHBOUND RAMP	0	0	1	0	0	1
HIGHWAY 52E AT HWY 35	0	0	0	1	0	1
HIGHWAY 52E AT RACQUET CLUB PKWY/HUNTLEY PKWY	0	0	0	0	1	1
TOTALS	1	1	1	1	1	5

ITS QUANTITIES

LOCATION	NETWORK DEVICE, TYPE C (FMES)	NETWORK DEVICE, UNLICENSED WMES	NETWORK DEVICE, CELLULAR MODEM	CAMERA, DOME			
	729C-020	729C-110	729C-200	729D-200			
	EACH	EACH	EACH	EACH			
HIGHWAY 52E AT HIGHWAY 33	1	1	0	0			
HIGHWAY 52E AT I-65 SOUTHBOUND RAMP	1	1	1	1			
HIGHWAY 52E AT I-65 NORTHBOUND RAMP	1	1	0	0			
HIGHWAY 52E AT HWY 35	1	1	0	0			
HIGHWAY 52E AT RACQUET CLUB PKWY/HUNTLEY PKWY	1	0	0	1			
TOTALS	5	4	1	2			

REFERENCE PROJECT NO
SCP 59-940-23

FISCAL YEAR
2023

SHEET NO
3A

REFERENCE PROJECT NO	FISCAL YEAR	SHEET NO
SCP 59-940-23	2023	4

TRAFFIC SIGNAL CONSTRUCTION PLAN HIGHWAY 52E AT HIGHWAY 33

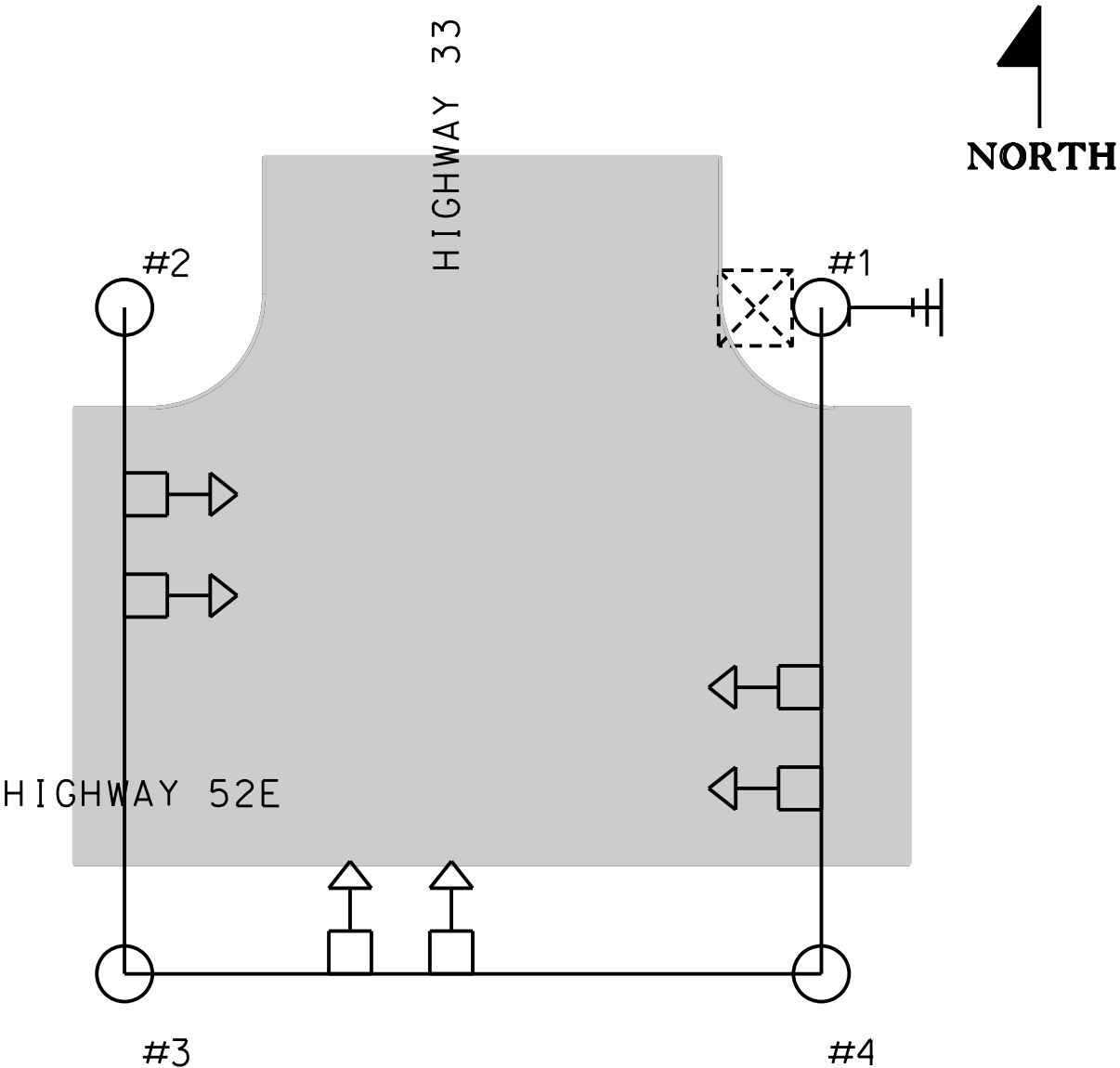

MATERIALS INCLUDED IN PAY ITEM 730C-000:
MISC. CABLES/ MOUNTING HARDWARE/CABINET MODIFICATIONS REQUIRED FOR INSTALLATION OF CONTROLLER & NETWORK DEVICES

SCOPE OF WORK HIGHWAY 52E AT HIGHWAY 33

1. INSTALL REQUIRED WIRELESS RADIO ANTENNA ON TRAFFIC SIGNAL POLE 1.
2. INSTALL/ROUTE REQUIRED CABLE FROM ANTENNA TO TRAFFIC SIGNAL CABINET VIA EXISTING SIGNAL POLE/CONDUIT.
3. INSTALL REQUIRED WIRELESS RADIO EQUIPMENT INSIDE THE EXISTING CABINET AND CONNECT TO TRAFFIC SIGNAL CONTROLLER.
4. INSTALL NEW TRAFFIC SIGNAL CONTROLLER INSIDE THE EXISTING TRAFFIC SIGNAL CABINET. REMOVE THE EXISTING CONTROLLER AND RETURN TO SHELBY COUNTY.

TRAFFIC SIGNAL CONSTRUCTION PLAN HIGHWAY 52E AT I-65 SOUTHBOUND RAMP

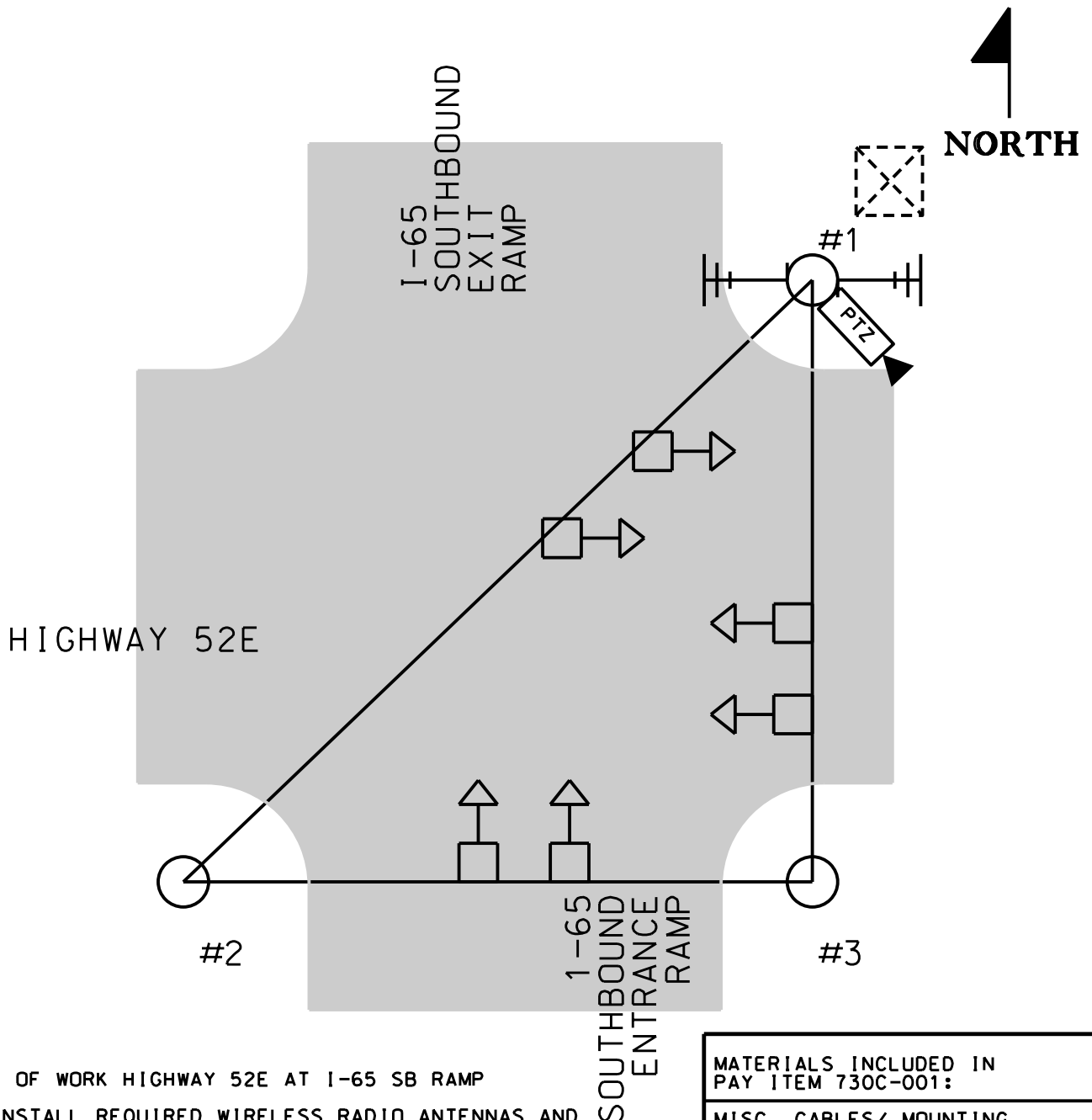

SCOPE OF WORK HIGHWAY 52E AT I-65 SB RAMP

1. INSTALL REQUIRED WIRELESS RADIO ANTENNAS AND CELLULAR MODEM ON TRAFFIC SIGNAL POLE 1.
2. INSTALL/ROUTE REQUIRED CABLE FROM ANTENNA TO TRAFFIC SIGNAL CABINET VIA EXISTING SIGNAL POLE/CONDUIT.
3. INSTALL REQUIRED WIRELESS RADIO EQUIPMENT INSIDE THE EXISTING CABINET AND CONNECT TO TRAFFIC SIGNAL CONTROLLER.
4. INSTALL NEW TRAFFIC SIGNAL CONTROLLER INSIDE THE EXISTING TRAFFIC SIGNAL CABINET. REMOVE THE EXISTING CONTROLLER AND RETURN TO SHELBY COUNTY.
5. INSTALL REQUIRED NETWORK SWITCH AND FIBER OPTIC DROP CABLE FROM TRAFFIC SIGNAL CABINET TO EXISTING ITS CABINET ADJACENT TO THE TRAFFIC SIGNAL.

MATERIALS INCLUDED IN PAY ITEM 730C-001:

MISC. CABLES/ MOUNTING
HARDWARE/CABINET
MODIFICATIONS
REQUIRED FOR INSTALLATION OF
CONTROLLER & NETWORK DEVICES

TRAFFIC SIGNAL CONSTRUCTION PLAN HIGHWAY 52E AT I-65 NORTHBOUND RAMP

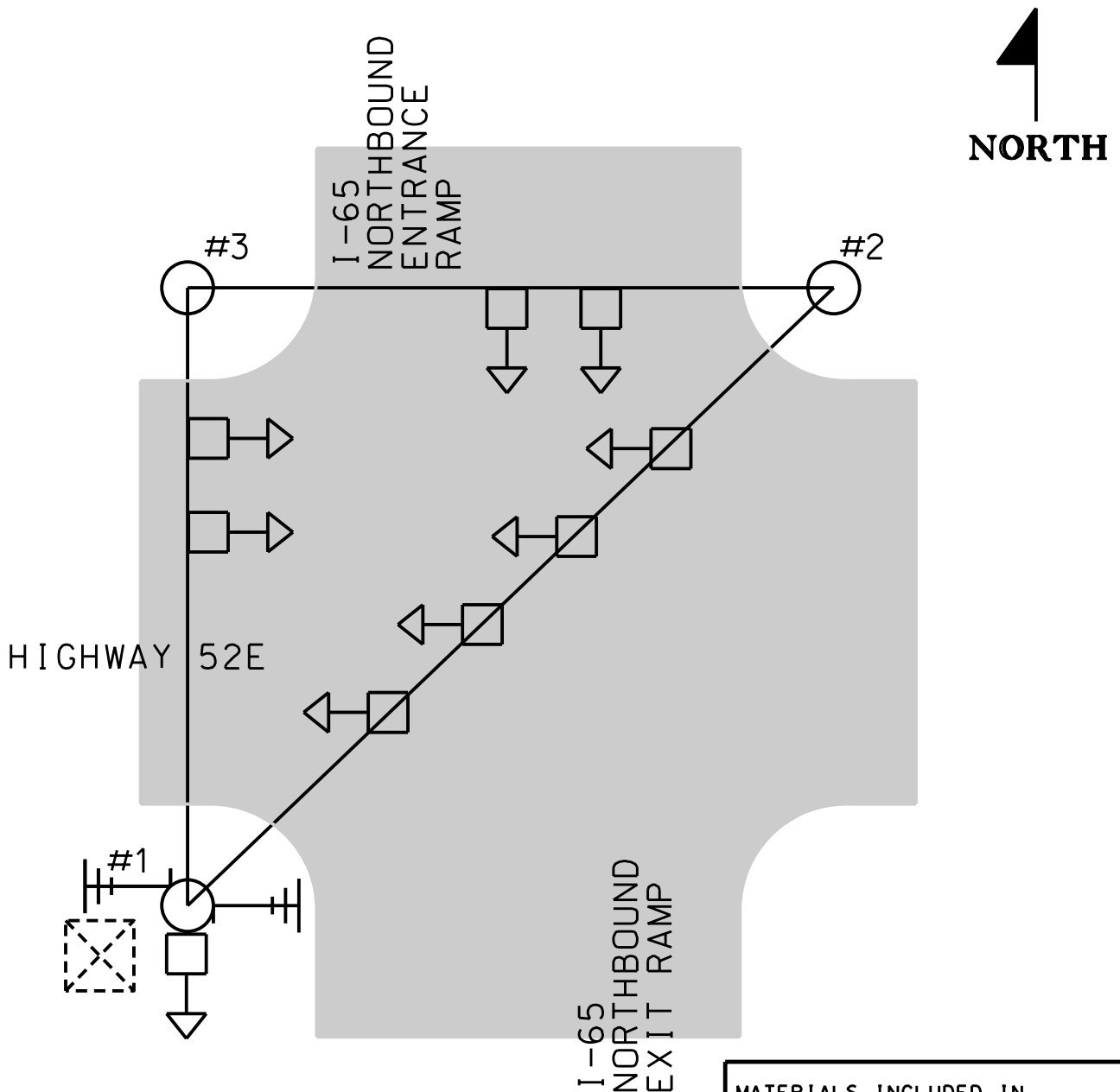

SCOPE OF WORK HIGHWAY 52E AT I-65 NB RAMP

1. INSTALL REQUIRED WIRELESS RADIO ANTENNA ON TRAFFIC SIGNAL POLE 1.
2. INSTALL/ROUTE REQUIRED CABLE FROM ANTENNA TO TRAFFIC SIGNAL CABINET VIA EXISTING SIGNAL POLE/CONDUIT.
3. INSTALL REQUIRED WIRELESS RADIO EQUIPMENT INSIDE THE EXISTING CABINET AND CONNECT TO TRAFFIC SIGNAL CONTROLLER.
4. INSTALL NEW TRAFFIC SIGNAL CONTROLLER INSIDE THE EXISTING TRAFFIC SIGNAL CABINET. REMOVE THE EXISTING CONTROLLER AND RETURN TO SHELBY COUNTY.

MATERIALS INCLUDED IN
PAY ITEM 730C-002:

MISC. CABLES/ MOUNTING
HARDWARE/CABINET
MODIFICATIONS
REQUIRED FOR INSTALLATION OF
CONTROLLER & NETWORK DEVICES

TRAFFIC SIGNAL CONSTRUCTION PLAN HIGHWAY 52E AT HIGHWAY 35

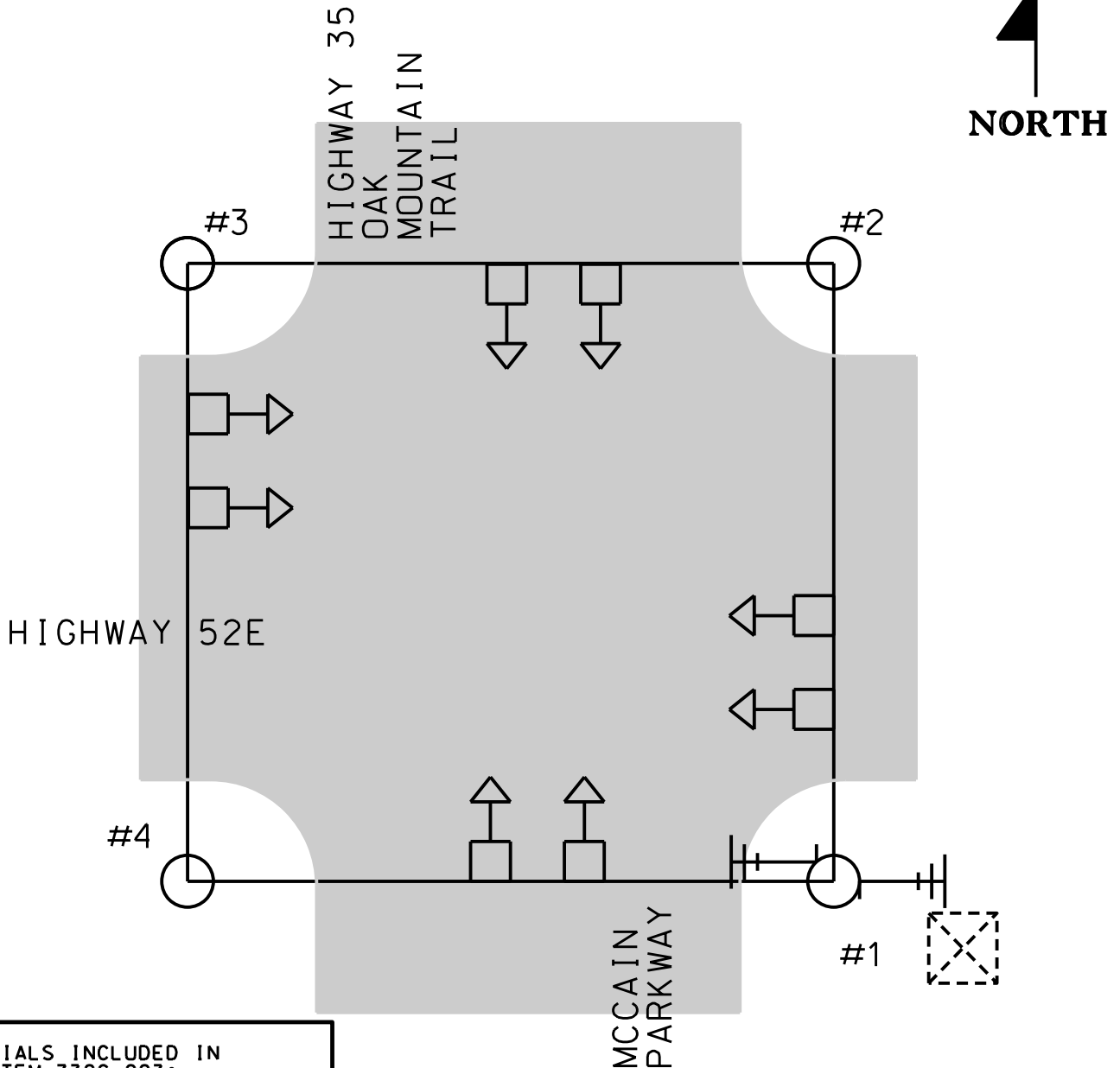

MATERIALS INCLUDED IN PAY ITEM 730C-003:

MISC. CABLES/ MOUNTING
HARDWARE/CABINET
MODIFICATIONS
REQUIRED FOR INSTALLATION OF
CONTROLLER & NETWORK DEVICES

SCOPE OF WORK HIGHWAY 52E AT MCCAIN PARKWAY & OAK MOUNTAIN TRAIL

1. INSTALL REQUIRED WIRELESS RADIO ANTENNA ON TRAFFIC SIGNAL POLE 1.
2. INSTALL/ROUTE REQUIRED CABLE FROM ANTENNA TO TRAFFIC SIGNAL CABINET VIA EXISTING SIGNAL POLE/CONDUIT.
3. INSTALL REQUIRED WIRELESS RADIO EQUIPMENT INSIDE THE EXISTING CABINET AND CONNECT TO TRAFFIC SIGNAL CONTROLLER.
4. INSTALL NEW TRAFFIC SIGNAL CONTROLLER INSIDE THE EXISTING TRAFFIC SIGNAL CABINET. REMOVE THE EXISTING CONTROLLER AND RETURN TO SHELBY COUNTY.

TRAFFIC SIGNAL CONSTRUCTION PLAN HIGHWAY 52E AT RACQUET CLUB PARKWAY & HUNTLEY PARKWAY

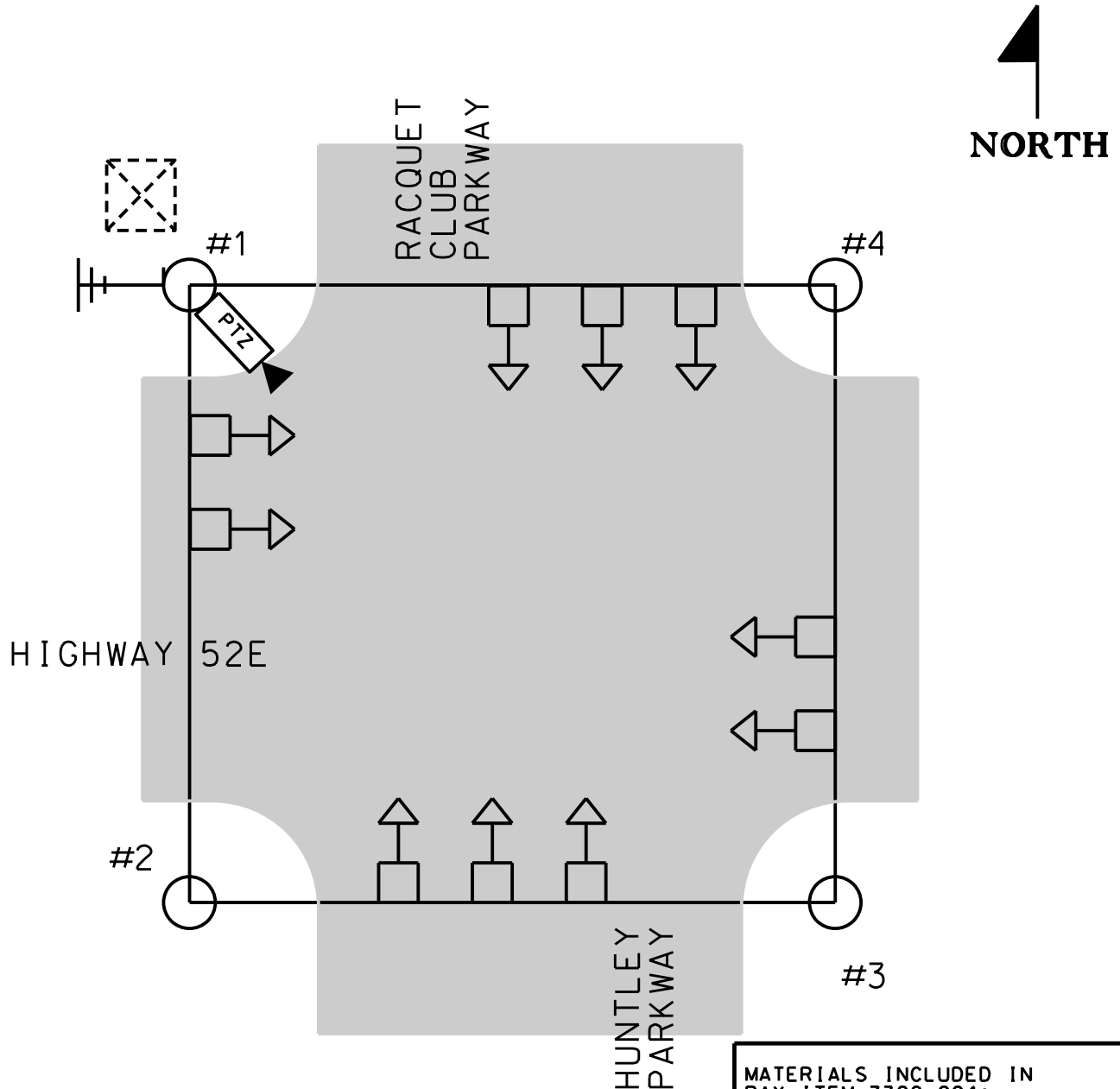

SCOPE OF WORK HIGHWAY 52E AT RACQUET CLUB PARKWAY & HUNTLEY PARKWAY

1. INSTALL REQUIRED WIRELESS RADIO ANTENNA ON TRAFFIC SIGNAL POLE 1.
2. INSTALL/ROUTE REQUIRED CABLE FROM ANTENNA TO TRAFFIC SIGNAL CABINET VIA EXISTING SIGNAL POLE/CONDUIT.
3. INSTALL REQUIRED WIRELESS RADIO EQUIPMENT INSIDE THE EXISTING CABINET AND CONNECT TO TRAFFIC SIGNAL CONTROLLER.
4. INSTALL NEW TRAFFIC SIGNAL CONTROLLER INSIDE THE EXISTING TRAFFIC SIGNAL CABINET. REMOVE THE EXISTING CONTROLLER AND RETURN TO SHELBY COUNTY.
5. INSTALL REQUIRED ETHERNET SWITCH IN THE EXISTING TRAFFIC SIGNAL CABINET.
6. INSTALL REQUIRED PTZ CAMERA ON POLE #1. ROUTE REQUIRED CABLE ALONG EXISTING TRAFFIC SIGNAL SPAN AND THROUGH THE EXISTING SIGNAL POLE AND CONDUIT TO THE EXISTING TRAFFIC SIGNAL CABINET

MATERIALS INCLUDED IN PAY ITEM 730C-004:

MISC. CABLES/ MOUNTING
HARDWARE/CABINET
MODIFICATIONS
REQUIRED FOR INSTALLATION OF
CONTROLLER, NETWORK DEVICES,
& PTZ CAMERA

ITS PLAN SCHEMATIC DETAIL

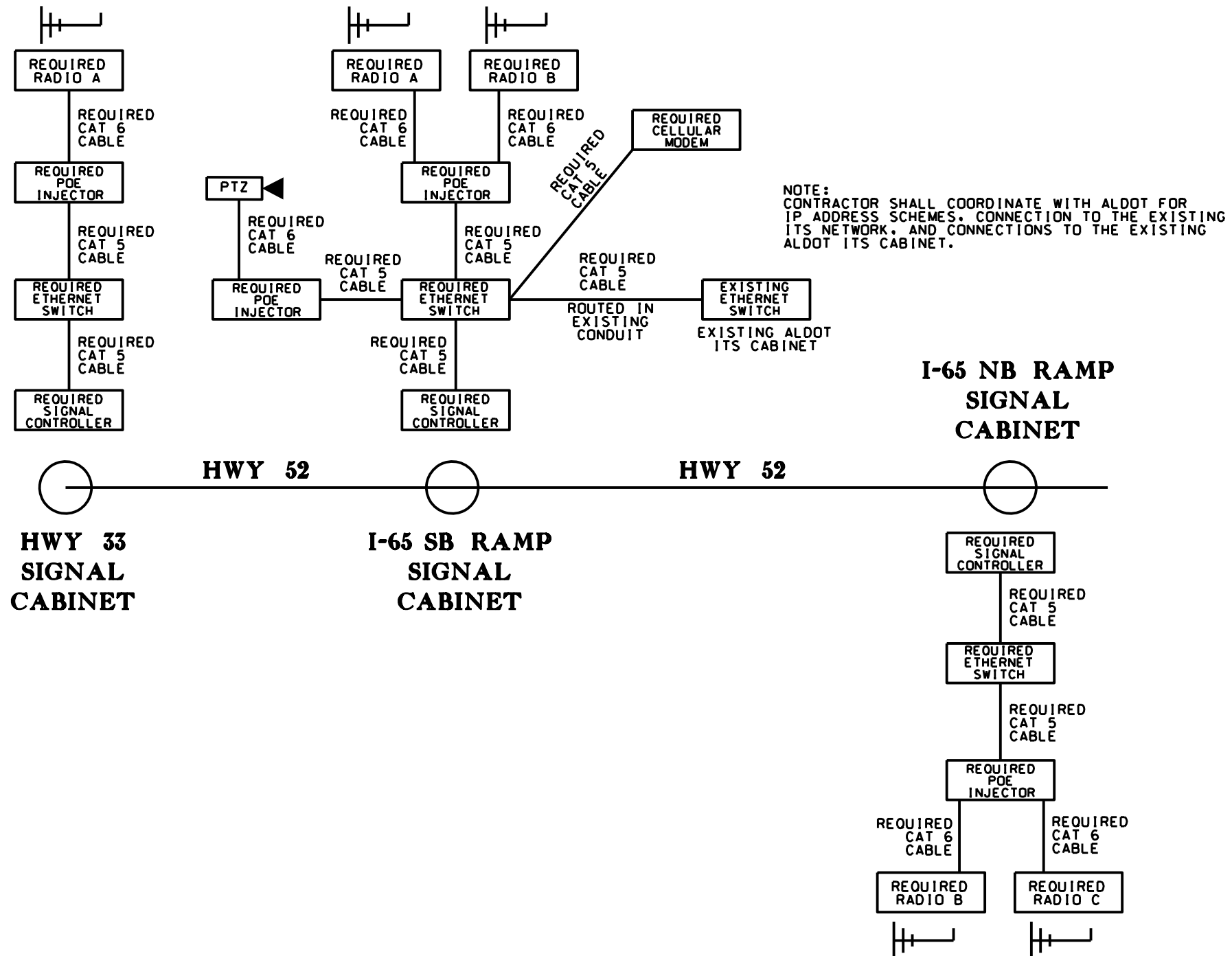

SCP 59-940-23

REFERENCE PROJECT NO

2023

FISCAL YEAR

9

SHEET NO

ITS PLAN SCHEMATIC DETAIL

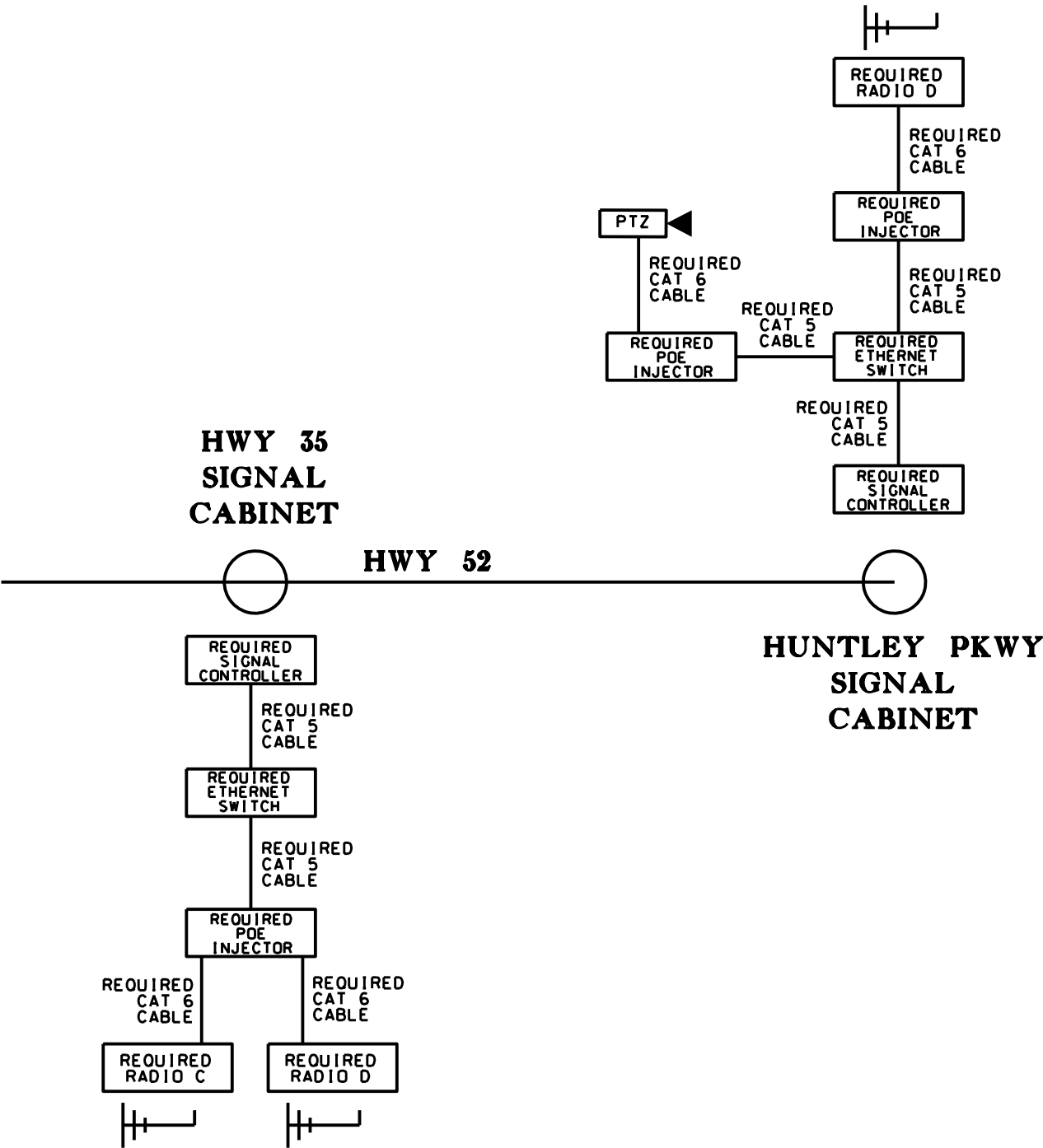

REFERENCE PROJECT NO	FISCAL YEAR	SHEET NO
SCP 59-940-23	2023	10

REFERENCE PROJECT NO

FISCAL YEAR

SHEET NO

TEMPORARY TRAFFIC CONTROL PLAN SHEET

TRAVELWAY

PAVEMENT WIDENING OR SHOULDER AREA

DRUMS @ 50' INTERVALS

4:1 SLOPE

WEDGE MATERIAL TO BE SUBSIDIARY OBLIGATION OF THE ADJACENT LAYER

(FOR USE WHERE EXCAVATION HAS BEEN DONE, BUT WIDENING IS NOT COMPLETED BY NIGHTFALL OR WHERE PAVEMENT DROP OFF OF RESURFACING PROJECTS IS 3" OR MORE AT NIGHTFALL)

TYPICAL FOR DROP-OFF AT EDGE OF PAVEMENT

NOTE:

THE CONTRACTOR IS TO CONSTRUCT A WEDGE OF UNCLASSIFIED EXCAVATION OR CRUSHED AGGREGATE BASE. THE COST OF PLACING AND REMOVAL SHALL BE A SUBSIDIARY OBLIGATION OF THE ADJACENT LAYER.

CHANNELIZING DRUMS SHALL BE PLACED AT 50 FT INTERVALS.

← OR →

EDGE OF PAVEMENT

EDGE OF PAVEMENT

30' BEGIN TAPER

REFLECTORIZED CHANNELIZING DRUMS

25'

100' TAPER

50'

SEE NOTE NO 2

REFLECTORIZED CHANNELIZING DRUMS ALONG THE EQUIPMENT PARKING AREA.

EQUIPMENT PARKING AREA

NOTES:

1. SEE ALDOT'S GENERAL TRAFFIC CONTROL PLAN NOTE NO. 702.

2. DRUMS TO BE AS FAR AS PRACTICAL FROM EDGE OF PAVEMENT. MINIMUM DESIRABLE DISTANCE IS 15 FEET FOR FREEWAY TYPE FACILITIES AND 10 FEET FOR OTHER FACILITIES. FOR UNUSUAL CONDITIONS, SUCH AS SPECIAL EQUIPMENT OR LIMITED AVAILABLE SPACE, DIMENSIONS LESS THAN DESIRABLE SHALL BE AS DIRECTED BY THE ENGINEER.

3. ALL DEVICES TO BE FURNISHED BY THE CONTRACTOR WITHOUT COST TO THE ALDOT.

DELINEATING DETAIL FOR EQUIPMENT PARKING OR STORING AREA

R5-1 30" X 30"

R11-2 48" X 30"

R11-3a 60" X 30"

SIGN

W1-6 48" X 24"

M4-10 48" X 18"

SIGN

ROAD CLOSED

DETOUR

DETAILS FOR TYPICAL PLACEMENT OF TYPE III BARRICADES INSIDE OF CLEAR ZONE

R5-1 30" X 30"

R11-2 48" X 30"

R11-3a 60" X 30"

SIGN

W1-6 48" X 24"

M4-10 48" X 18"

SIGN

ROAD CLOSED

DETOUR

DETAILS FOR TYPICAL PLACEMENT OF TYPE III BARRICADES OUTSIDE OF CLEAR ZONE

NOTES

1. SLOPE OF STRIPES ON BARRICADES SHALL BE IN ACCORDANCE WITH SECTION 6F.68 OF THE MUTCD AND DRAWING B-107-2.

2. IF SIGNS ARE REQUIRED TO BE USED IN CONJUNCTION WITH TYPE III BARRICADES TO BE PLACED INSIDE THE CLEAR ZONE, THEY SHALL BE POST MOUNTED TO THE SIDE OF THE BARRICADES AS SHOWN.

3. IF ROAD CLOSED OR DETOUR SIGNS ARE REQUIRED TO BE USED WITH TYPE III BARRICADES TO BE PLACED OUTSIDE THE CLEAR ZONE, THEY SHALL BE PLACED ON THE TOP OF THE BARRICADES NEAREST THE DETOUR.

ALABAMA DEPARTMENT OF TRANSPORTATION

1405 COLLEEN DR. DOLENTOWN, AL 36139-3009

THIS DRAWING REPRESENTS DESIGNS PROVIDED FOR USE BY THE ALABAMA DEPARTMENT OF TRANSPORTATION AND IS NOT TO BE COPIED, REPRODUCED, ALTERED, OR USED BY ANYONE OR ANY ORGANIZATION WITHOUT THE EXPRESSED WRITTEN CONSENT OF THE ALABAMA DEPARTMENT OF TRANSPORTATION REPRESENTATIVE AUTHORIZED TO APPROVE THIS USE. ANYONE MAKING UNAUTHORIZED USE OF THIS DRAWING MAY BE PROSECUTED TO THE FULLEST EXTENT OF THE LAW.

Revised

Corrected text overlap on 12-6-2021 by DJLW.

Revised Set Date

08/26/2021

Drawn By

1

Date Drawn

1

Revised Date

12/29/2021

DESIGN BUREAU SPECIAL DRAWING

STANDARD DETAILS FOR TRAFFIC CONTROL PLANS

NOT TO SCALE

SPECIAL PROJECT DETAIL

2801

